

SAFETY-TREAD® LADDER RUNGS

Safety-Tread® ladder rungs are small channel shaped sections; the web of the channel being the walking surface which is covered with small perforated dimples, produced by a cold forming process.

FEATURES & BENEFITS

- Perforated dimples provide superior slip resistance in all directions and in all weather conditions. The quantity of dimples under foot provides exceptional adhesive friction.
- Cross sectional design provides significant load carrying capacity on spans up to 24”.
- Three widths of rung to choose from.
- Leading row of dimples projected on the edge of the rung provides slip resistance to the foot approaching at an angle to the walking surface.
- Long life span requiring little maintenance.
- Adaptable to a wide range of applications.
- Easily adaptable to cost effective, custom fabrication.
- Ideal for retrofit applications as rungs fit over slippery pipes, bars, etc. on existing ladders.



MATERIAL SPECIFICATIONS

Ladder rungs shall be “Safety-Tread® ladder rungs,” manufactured from (see ‘Selections’ below).

SELECTIONS

- ASTM-A-1011, 13 or 11 gauge, HRP&O steel.
- ASTM-A-653, 13 or 11 gauge, G-90 (Z-275) Pre-galvanized steel.
- 5052H32 .125” thick, Aluminum.
- Type 316L, 14 gauge Stainless Steel.

1 1/4” wide (2 hole)

Type	Weight lb/ft	Load/Type	CLEAR SPAN (in)				
			16”	18”	20”	24”	30”
Carbon Steel 11ga	1.2	C	375	333	300	250	200
		D	0.02	0.02	0.03	0.04	0.07
Stainless Steel 14ga	1.0	C	375	333	300	250	200
		D	0.03	0.04	0.05	0.07	0.11
Aluminum 0.125in	0.52	C	313	278	250	208	
		D	0.04	0.05	0.06	0.08	

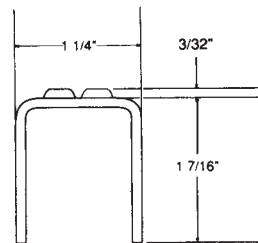

NOTE:

C = Allowable concentrated load (lbs)

D = Corresponding deflection (in) resulting from C.

All concentrated loads include a safety factor of 4.0, based on ultimate strength.

Ladder rungs showing concentrated load “C” at 200 lbs or above comply with OSHA standard 29CFR 1910.27(a)(1)(i) under the title “Walking-Working Surfaces—Fixed Ladders.”

Ladder rungs showing concentrated load “C” at 250 lbs or above comply with OSHA standard 29CFR 1917.120(b)(1) under the title “Terminal Facilities—Fixed Ladders.”

Tolerance of all dimensions ±1/8”.

Standard lengths are 5ft.

1 5/8” wide (3 hole)

Type	Weight lb/ft	Load/Type	CLEAR SPAN (in)				
			16”	18”	20”	24”	30”
Carbon Steel 13ga	1.3	C	313	278	250	209	
		D	0.02	0.03	0.04	0.06	
Stainless Steel 14ga	1.1	C	250	222	200		
		D	0.03	0.04	0.04		
Aluminum 0.125in	0.5	C	250	222	200		
		D	0.04	0.05	0.06		

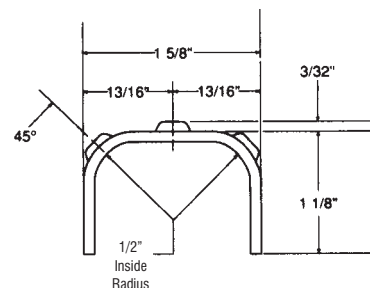

2 1/4” wide (4 hole)

Type	Weight lb/ft	Load/Type	CLEAR SPAN (in)				
			16”	18”	20”	24”	30”
Carbon Steel 13ga	1.5	C	375	333	300	250	200
		D	0.02	0.02	0.03	0.04	0.07
Stainless Steel 14ga	1.2	C	468	416	375	312	250
		D	0.03	0.04	0.05	0.07	0.10
Aluminum 0.125in	0.5	C	375	333	300	250	200
		D	0.03	0.04	0.05	0.07	0.11

